







**APPENDIX E4
PARAMETER PLAN**

REVISIONS			
A	11/10/16	A.G.	R.T.
PHASE 1 WORKS SHOWN, ARROWS & PATHS UPDATED			
B	18/10/16	A.G.	R.T.
APPLICATION BOUNDARY ALTERED, DEVELOPMENT PLOT SHADING ADDED, ARROWS AMENDED			
C	28/10/16	A.G.	R.T.
APPLICATION BOUNDARY ALTERED, BUS STOPS ADDED, ARROW LOCATIONS UPDATED			
D	28/10/16	A.G.	R.T.
APPLICATION BOUNDARY REVISED			
E	02/11/16	A.G.	R.T.
APPLICATION BOUNDARY REVISED			
F	28/05/17	A.G.	A.H.
WIDENING & EXTRA LANES SHOWN AT END OF MOTORWAY, ROUNDABOUTS ADJACENT RETAIL ALTERED			
G	28/07/17	A.G.	A.H.
ACCESS POINTS FROM STANFIELD LANE REVISED			

- KEY**
-  PROPOSED APPLICATION BOUNDARY
 -  DENOTES AREA OF LAND TO BE EXCLUDED FROM APPLICATION
 -  PROPOSED VEHICULAR ACCESS POINTS
 -  EXISTING PEDESTRIAN / CYCLE ACCESS POINT
 -  PROPOSED PEDESTRIAN / CYCLE ACCESS POINT
 -  PROPOSED BUS STOP
 -  PROPOSED PEDESTRIAN ACCESS POINT
 -  EXISTING PUBLIC RIGHTS OF WAY TO BE RETAINED AND RE-ALIGNED WHERE NECESSARY (FINAL ROUTE MAY ALTER FROM THAT SHOWN)

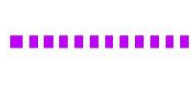
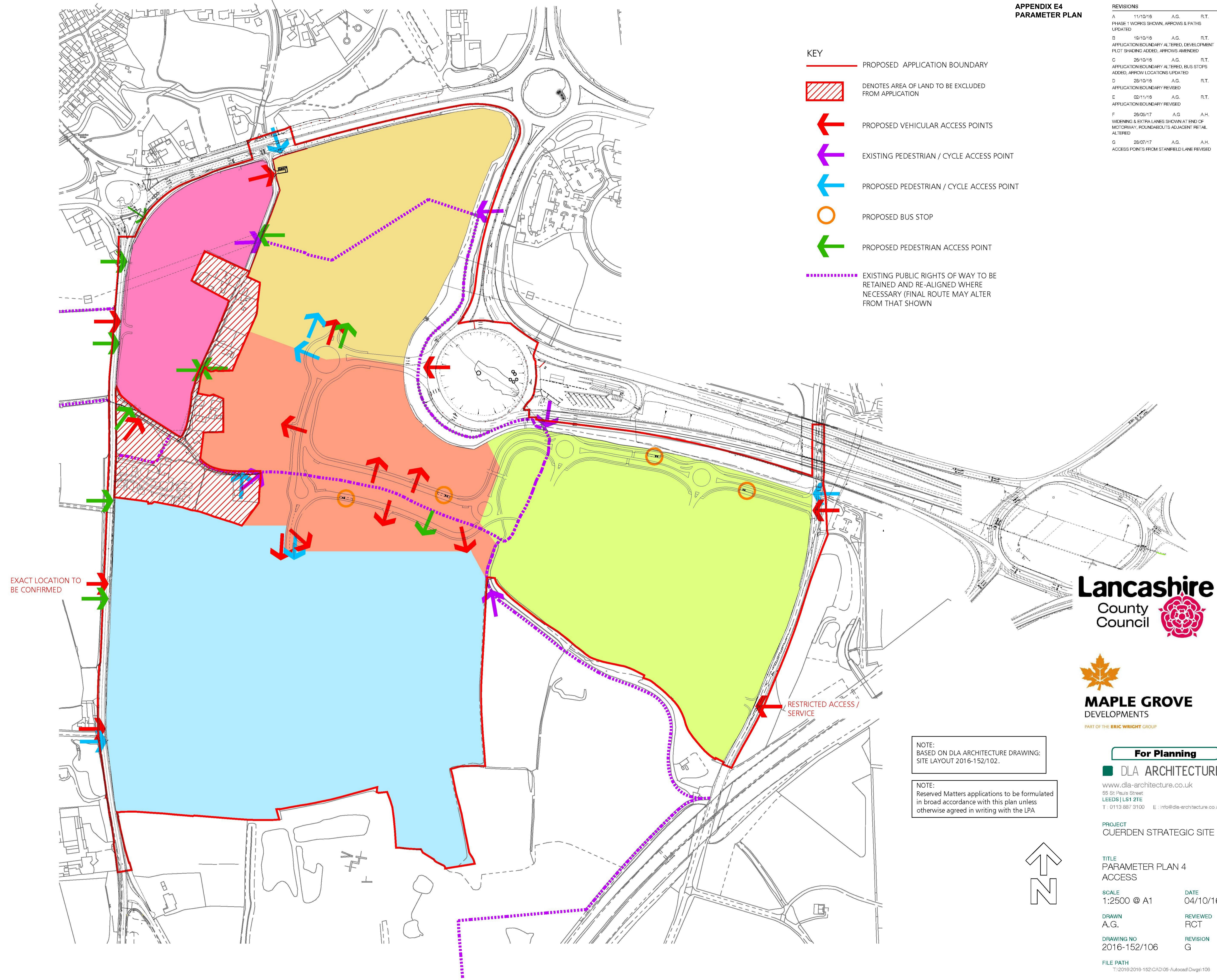

EXACT LOCATION TO BE CONFIRMED

RESTRICTED ACCESS / SERVICE

NOTE:
BASED ON DLA ARCHITECTURE DRAWING:
SITE LAYOUT 2016-152/102.

NOTE:
Reserved Matters applications to be formulated
in broad accordance with this plan unless
otherwise agreed in writing with the LPA



**MAPLE GROVE
DEVELOPMENTS**
PART OF THE ERIC WRIGHT GROUP

For Planning
DLA ARCHITECTURE

www.dla-architecture.co.uk
55 St Pauls Street
LEEDS | LS1 2TE
T : 0113 887 3100 E : info@dl-a-archtecture.co.uk

PROJECT
CUERDEN STRATEGIC SITE

TITLE
PARAMETER PLAN 4
ACCESS

SCALE
1:2500 @ A1

DATE
04/10/16

DRAWN
A.G.

REVIEWED
RCT

DRAWING NO
2016-152/106

REVISION
G

FILE PATH
T:\2016\2016-152\CAD\05-Autocad\Drawgs\106

